

MDFD-1

Micro Drop Fog Dispenser



Technical Specification

Single head ultrasonic fog generator system model MDFD -1



Used best for rooms size	10' x 10' x 8' - 800 cubic feet or 23 cubic meters
Capacity (water consumption)	0.4 to 0.6 liter / hour
Electrical specifications	100 to 240 Volts, 50/60 Hz , 1.6 A max
Recommended water pressure	40-60 lbs. / inch (275 to 415 kpa)
Water intake	½" (12.70 mm)
Fog outlet	1 ½" (38 mm)
Dimensions:	Length: 18" (457 mm) Width: 7" (178 mm) Height: 14" (355 mm) without fog hose Weight: 7 lbs. (3.175 kg)
<ul style="list-style-type: none"> - 1 x EBU (the ultrasonic fog unit) - 1 x Waterproof fan - Water Float valve - Automatic shut off water sensor. - Protection against electrical overload, complies with C.S.A. C.22.2 and U.L998 - F.D.A. Grade (Food and Drug Approved): All components in contact with water and fog are grade F.D.A. plastic made. - One year warranty 	

OWNER'S GUIDE

Single Head Ultrasonic Fog Generator

Made in Québec, Canada

MDFD-1

Micro Drop Fog Dispenser



Producing water droplets smaller than 5 microns

OTHER PRODUCTS:

4-Heads ultrasonic fog generator system model MDFD-4

- Used best for rooms size: 16' x 16' x 8' - 2048 cubic feet or 58 cubic meter
- Capacity (water consumption): 1.6 to 2.4 liter / hour
- Electrical spec: 100 to 240 volts 50-60Hz, 6A max
- Recommended water pressure: 40-60lb/inch (275-415 kPa)
- Water intake: ½" (12.70 mm)
- Fog outlet: 6" (152.4 mm)
- Dimensions: Diameter: 23" (584 mm)
Height: 26" (660 mm)
Weight: 34lbs (15.45kg)
- 4 x EBU's (the ultrasonic fog generator unit)
- 6 x Waterproof fans.
- Water Float valve
- Automatic shut off water sensor
- Electronic malfunction alarm system
- C.S.A. - U.L.
- One year warranty
- Made in Quebec, Canada



6-Heads ultrasonic fog generator system model MDFD-6

- Used best for rooms size: 22' x 22' x 8' - 3872 cubic feet or 93 cubic meter
- Capacity (water consumption): 2.4 to 3.6 liter / hour
- Electrical spec: 100 to 240 volts 50-60Hz, 6A max
- Recommended water pressure: 40-60lb/inch (275-415 kPa)
- Water intake: ½" (12.70 mm)
- Fog outlet: 6" (152.4 mm)
- Dimensions: Diameter: 23" (584 mm)
Height: 26" (660 mm)
Weight: 34lbs (15.45kg)
- 6 x EBU's (the ultrasonic fog generator unit)
- 6 x Waterproof fans.
- Water Float valve
- Automatic shut off water sensor
- Electronic malfunction alarm system
- C.S.A. - U.L.
- One year warranty
- Made in Quebec, Canada



HT2 Digital Controller Single output Bar graph display

- Day and Night temperature settings: 48°F to 104°F (9°C to 40°C)
- Day and Night humidity settings: 10% to 100%
- User can select one among five operating modes: Cooling, Cooling & Dehumidifying, Dehumidifying, Humidifying, Heating
- User-Set Low-Temperature Limit (for Cooling & dehumidifying mode only)
- Remote Sensor w/ 25-ft cable (included)
- Non-condensable sensor.
- Interchangeable sensor.
- Bar graph display
- 15 Amps Output
- Electrical specifications: maximum load: 120 volts load max 15A (50/60 hz)
- 3 years warranty
- Made in Quebec, Canada



5245 Rue des Cageux, Pierrefonds
Quebec H9J 3C4 - CANADA
Phone: 514-892-0246 | Fax: 514-784-0242
Email: info@theotekgroup.com
www.theotekgroup.com

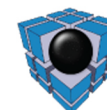

THEOTEK GROUPE INC.

Read all instructions before installation.
Save for future reference.

INSTALLATION

Warning: Do not install the Fog Generator in the same room or zone that is being fogged.

Warning: Always make sure the water is at the optimal level in the water tank and torch before powering the EBU.

1. Use the 2 installation holes on the wall plate to install the fog generator, making sure it is leveled.
2. Use a ½" hose (12.70 mm) and hose clip to connect the water supply to the water intake located on the right side of the unit. We recommend, on the main water supply line, the installation of an on/off valve, to be able to shut off the water supply during maintenance, repair or storage. Make sure, upon the water hose installation that the water valve floater, in the interior of the water tank did not rotate and it maintained the horizontal position.
3. Open the water supply valve. Wait until water stops filling the water tank.
4. Check the water level in the torch. The water level in the torch should be ¼" (6 mm) higher than the window middle line.
5. Attach the fog hose to the fog exhaust outlet using the 45° adaptor.
6. Connect the EBU connector cable to the wall plate white cable connector on the left side of the unit. Waterproof the connection by rotating the lock plastic ring attached to the connector.
7. Connect the power supply connector to the power connector located on the left side of the wall plate. Plug the power cable, of the power supply, to a power source. When the power is connected the green led light on the power supply will be on and the fan will start working.
8. Connect the water level sensor white connector, coming from the wall plate with the connector on the water tank cover. The unit will start generating dry fog.
9. Install the front cover of the fog generator.

WARNINGS

1. Always install the power supply as far away as possible from the fog generator.
2. Do not operate the fog generator when the temperature is below the freezing point.
3. In case of using a reverse osmosis water filtration system, it must be kept a minimum of 15ppm (15 parts per million) of dissolved salts in the water for the automatic safety shut-off water sensor to be operational, otherwise the fog generator will not start.
4. If you attach a supplementary hose to the existing one, it must be positioned vertically or with a downward inclination to avoid water accumulation.
5. The fog generator is equipped with an automatic safety shutoff water sensor. It will immediately turn off the unit if the water level is too low, preventing it from being damaged. It will instantly start up again when water is added. The fog generator will not work if the sensor is unplugged.

For troubleshooting instructions please consult our Customer Service page on our website www.theotekgroup.com or contact our 24h Customer Service Department by phone at 514-892-0246 or email at info@theotekgroup.com

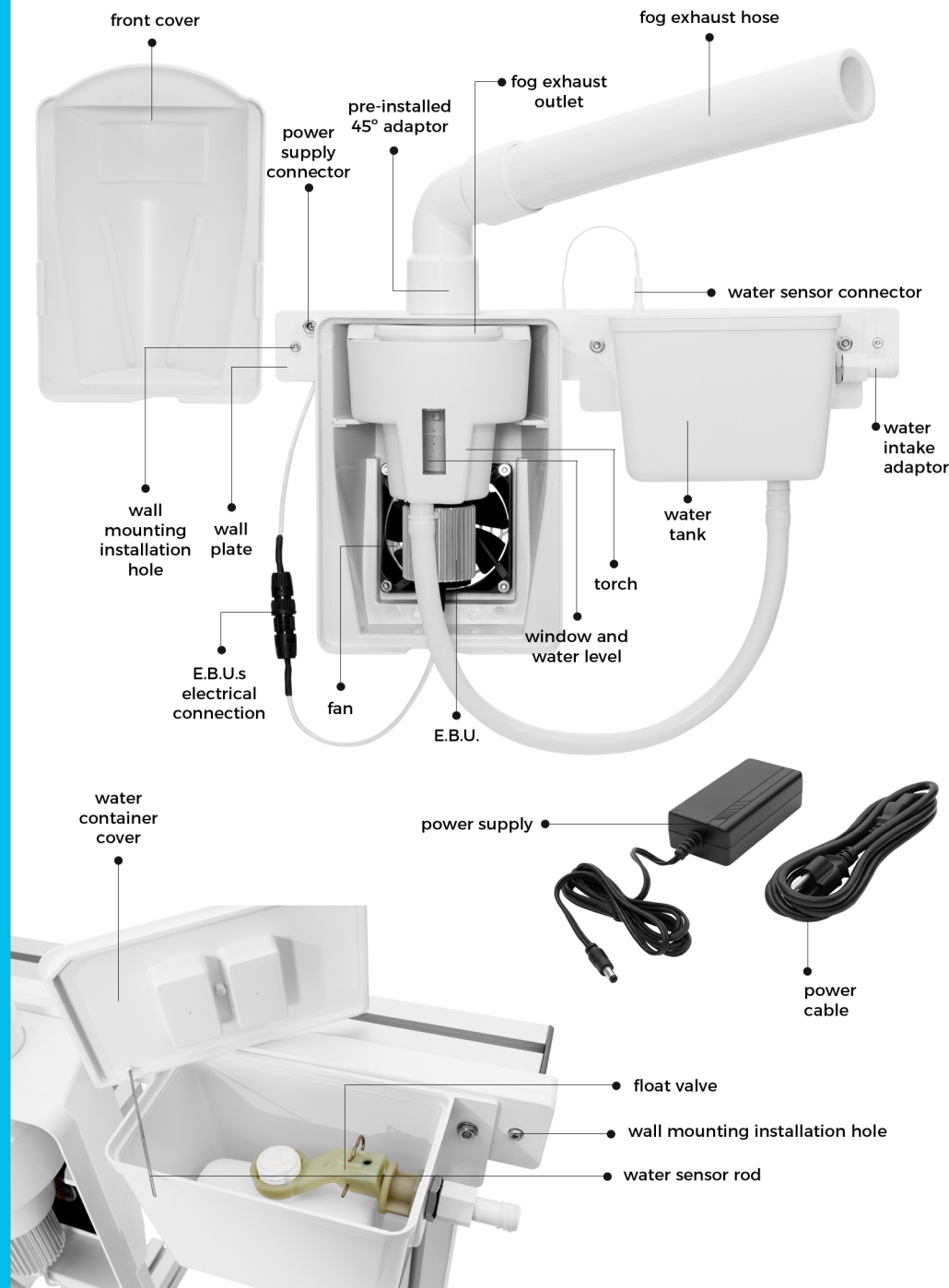

Limited Warranty

One (1) year from date of purchase on parts and labour with proper functioning of the unit. Repair or replacement at our discretion. Shipping and handling at customer's expenses. (Contact us for our return policy).

LIMITED WARRANTY ACCORDING TO SPECIFICATIONS, CONDITIONS AND RESTRICTIONS. WARRANTY VOID IF MISUSED.



MAINTENANCE

Maintenance, cleaning or replacing the EBU procedures

For an optimal functionality and durability of the fog generator we recommend the cleaning of the EBU to be done each 3 -4 months, depending on the environment is used and the quality of the water source. In some cases an online water filter is required.

1. Unplug the power supply from power source.
 2. Close water supply valve.
 3. Disconnect fog hose.
 4. Remove the front cover.
 5. Disconnect EBU's electrical connection.
 6. Empty the water from the system by removing the torch from its position and turning it upside down over an empty container.
 7. Unscrew the EBU from the torch and remove the rubber gasket.
 8. Clean the EBU's top surface with a combination of water and vinegar or calcium remover using a soft clean tissue. This operation must be handled with care to not scratch or damage the fog generating surface.
 9. Clean also the tip of the water sensor rod attached to the water tank cover.
 10. If the torch needs to be clean, detach the water alimentation hose from the torch, and submerge the torch on the container in a combination of water and vinegar or calcium remover for a half an hour then rinse with clean water and reattached the water alimentation hose.
 11. Install the EBU by first inserting the clean rubber gasket and then screwing back the EBU in the torch.
 12. Open the water supply valve. Wait until the water stops filling the water tank. Water level in the torch should be ¼" (6 mm) higher than the window middle line.
 13. Connect the fog hose to the fog exhaust outlet using the 45° adaptor.
 14. Attach the EBU connector to the wall plate white cable connector on the left side of the unit.
 15. Waterproof the connection by rotating the lock plastic ring attached to the wall plate connector.
 16. Connect the power supply connector to the power connector located on the left side of the wall plate. Plug the power cable, of the power supply, to a power source. When the power is connected the green led light on the power supply unit will be on and the fan will start working.
 17. Connect the water level sensor white connector coming from the wall plate to the connector on the water tank cover. The unit will start generating dry fog.
 18. Install the front cover of the fog generator.
- WARNING:** If cleaning is not done regularly, the unit will stop working and may get damaged.

STORAGE

If the fog generator is not used for more than a few days, the power supply should be unplugged from the power source, the water supply valve should be turned off, and the water should be removed from the torches and the water tank. The EBU's and water sensor rod should be cleaned, following cleaning procedure for the future use. Protect the fog generator by covering the system in the period of non-use.